

FAECAL COLLECTION KIT

A faecal collection kit used for the collection and transportation of samples for laboratory analysis of human haemoglobin, biochemical and/or immunological parameters

This kit contains the materials required for either sample self-collection or collection by a health/social care professional.



For *in vitro* diagnostic use,
sample self-collection



KT430



Carefully read the
enclosed instruction
leaflet before use



Important: Do not use kit
if security seal is broken.
Keep out of reach of children



Do not re-use



For use by persons
aged 18 and over

Sample collection instructions (Steps 1–18)

- Please ensure the kit is within expiry date and read these instructions carefully and completely before attempting to collect the sample.
- If your kit requires online activation, please follow the instructions provided by your healthcare organisation. If you need assistance please contact the healthcare organisation who arranged the test.

Your sample collection kit contents

Please check that the kit contains all of the items outlined below.
Do not proceed with sample taking if any items are missing or damaged,
contact the healthcare organisation who arranged your test for assistance.

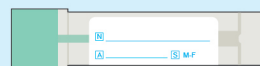

Green sampling stick and tube
for taking your sample, c€ IVD

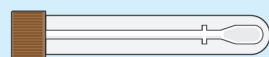

Brown sampling stick and tube
for taking your sample (x2), IVD



Return security label



Sample label (x3)

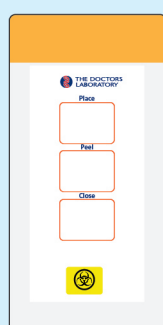

Transport pouch
with absorbent pad

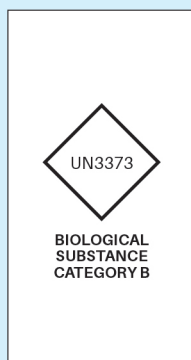

Return postal box

3



Wash and dry your hands.

4

Clearly complete the three
sample collection tube labels
using a ball point pen with:

- Your First name
- Your Surname
- Your Date of birth
- Sample type:
Faecal



5

The return postal box has a postal tracking label applied. Please make a note
of the unique tracking number displayed under the barcode on the postal
tracking label, as shown below. Keep this in a safe place for future reference.

**You can track delivery of your Royal Mail parcel by entering this number
using the following link: <http://www.royalmail.com/track-your-item>**



**Write your tracking number here
for reference – keep this safe.**

6

Affix the label to the green
sampling stick collection
tube as shown.

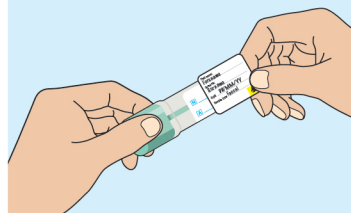

7

Affix a label to both of
the brown sampling stick
collection tubes as shown.

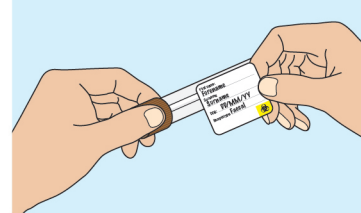

8

Take the green
collection tube.
Twist the green
cap to open
and pull out the
sample stick.

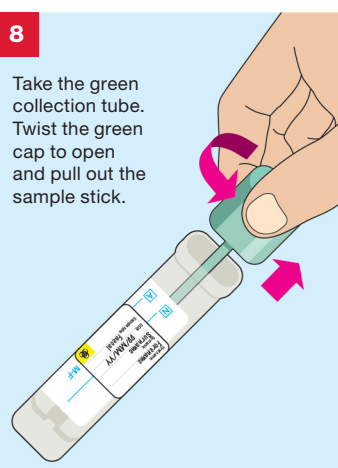

9

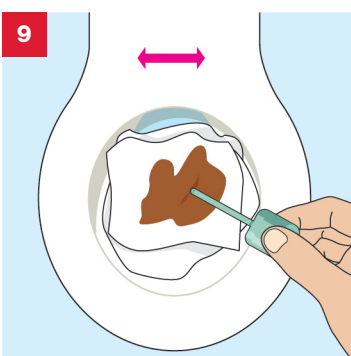

Collect your sample by scraping
the sampling stick on your bowel
motion (stool) until the end of
the stick is covered.

FAECAL SAMPLE COLLECTION

1

If not already pre-populated
please complete the test
request form, provided by
your doctor/clinic, separate
to this kit. **Make sure
the sample date is
completed.**



2

The test can be done at any time of
day or night. Place a bed of toilet
paper in the bowl to make it easier
to collect your sample. Perform
your bowel motion. If possible,
try to prevent the sample
from touching the water.



10

Please make
sure the ridged
end of the stick is
covered in stool.

An even amount
stool is required,
too little or too
much is not
suitable for testing.

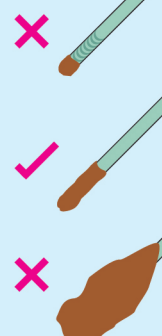

11

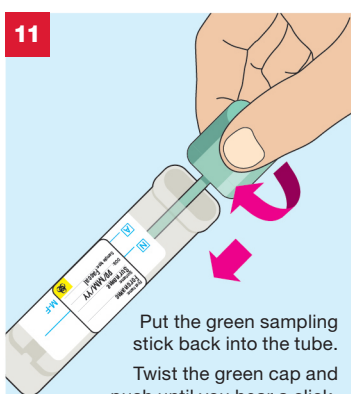

Put the green sampling
stick back into the tube.
Twist the green cap
and push until you hear a click.
Do not reopen the tube.

12

Take a brown collection tube. Hold it in clean toilet tissue.

Twist the cap to open and pull out the sample stick.

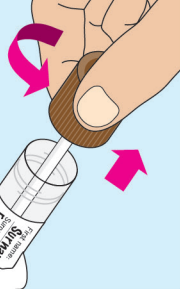

13

Collect your sample by scraping the sampling stick on your bowel motion (stool) until the end of the stick is covered.

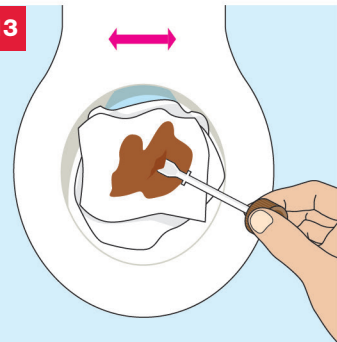

14

Drop the scoop of sample into the collection tube

Repeat the process so that 8-10 scoops are collected in the tube, this should fill the tube approximately halfway. **Do not fill the tube more than halfway.**

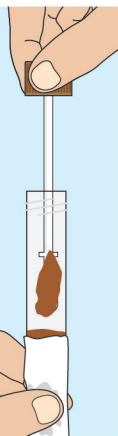

15

Put the sampling stick back into the tube and screw to close. Do not reopen the tube.

Please repeat steps 12 to 15 to take a sample using the second brown collection tube.

If any sample is on the outside of either collection tube please wipe it clean with damp tissue. Wash and dry your hands.

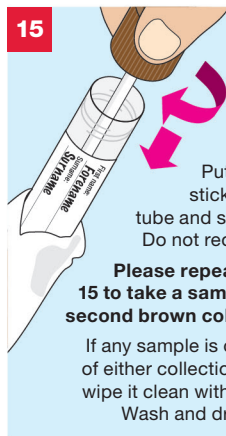

16

Place each sample tube into its own compartment in the transport pouch.

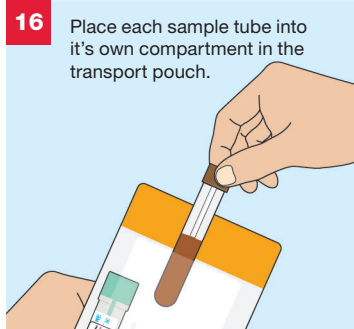

17

Peel off the adhesive backing strip, fold over the top flap and seal firmly.



18 IMPORTANT CHECKLIST

Before you return your sample please do the following:

- ☐ Place your completed request form supplied by your doctor/clinic into the kit tray
- ☐ Make sure that the green collection tube is labelled
- ☐ Make sure that both brown collection tubes are labelled
- ☐ Make sure the green and brown tubes are in the transport pouch and this is firmly sealed
- ☐ Place the transport pouch into the kit tray
- ☐ Slide the kit tray back into the return postal box
- ☐ Close the return postal box and apply the return security label to seal the end of the box
- ☐ Check that you have taken note of your postal tracking number

Please store at room temperature until posted.

Please post your sample to **The Doctors Laboratory** as soon as possible (ideally on same day or within 24 hours of sample collection) from **ANY** Royal Mail post box in the UK. No stamp is required within the UK.

If you need assistance please contact The Doctors Laboratory on **020 7307 7373** or email **samples@tdlpathology.com**.



We would welcome feedback on your experience of using this self-collection kit to help us improve our services. To complete a short online survey please scan the code or visit:

<https://forms.office.com/r/EZfeMc4TVs>

Warnings and precautions

- This kit is designed for use by persons aged 18 and over and upon request of a healthcare professional or healthcare organisation.
- Please consult with a healthcare professional for guidance on sample collection processes for adolescent and younger children.
- The kit should not be used by individuals lacking the physical or mental capacity to correctly follow the self-collection instructions. If you have problems or feel unwell or lightheaded during the collection process, please pause and if necessary, consult with your advising healthcare professional.
- Do not place the sampling stick directly into your body. The sample bottles are designed for collecting faecal samples, no other sample types.
- Do not obtain faecal samples during menstruation (your period) and avoid sample contact with lubricants, bleach and toilet cleaners.
- If your stool sample is excessively watery or hard please discuss this with your healthcare professional to ensure you are collecting a suitable sample for testing.
- Do not break the bottle seals, add water or remove the buffer.
- Liquid contained in the sealed sampling tube contains a hazardous material, sodium azide (NaN₃ <0.1%). Avoid contact with skin, eyes and mouth. In case of exposure, wash vigorously with water and contact a doctor for treatment advice. Further information can be found at www.fit-screening.co.uk
- Some haemoglobin variants may interfere with QFIT results, these results should be interpreted with caution.
- The accuracy of your results may be compromised if you do not read and follow the instructions in full.
- Samples arriving at the laboratory which show signs of degradation or general damage or arrive between 3–7 days of sample taking (depending on test requested) may not be tested.

Materials required but not provided

- Test request form.** This will be provided by your healthcare professional or healthcare organisation. **Please complete the request form with your details as instructed.**
- Clean tissue paper**

Laboratory Tests

- The tests and procedures undertaken by The Doctors Laboratory Limited are verified and performed in line with supplier product instructions for use and supported by additional validation data for use with self-collection procedures.
- Test results are provided in line with clinically approved results pathways, agreed between The Doctors Laboratory Limited and the patients designated healthcare professional or healthcare organisation.

KEY TO SYMBOLS

IVD	For in vitro diagnostic use		Manufacturer	UK CA	UK Conformity Assessed
REF	Catalogue number	EC REP	EU Authorised Representative	CE	EU Conformity Assessed
LOT	Batch code		Temperature limits: 4°–25°C		Do not re-use
	Biological risk. Biological sample, treat as potentially infectious		Caution, consult accompanying documents		Consult instructions for use
	Do not use if package is damaged		Keep away from sunlight	18+	For use by persons aged 18 and over
	Use by end of year-month		Distributor		Keep dry



REAL Digital International Limited, 2 Queensway, Croydon, Surrey, CR0 4BD, UK
Website: www.real-digital.co.uk



Casus Europe BV, Lange Viestraat 2 B, 3511BK Utrecht, The Netherlands.



The Doctors Laboratory Limited

Distribution is restricted to regions in which the product is registered by the manufacturer.

© The Doctors Laboratory Limited, 2025. Illustrations: © Jag Matharu/Thin Air Productions
RDI-IFU-029, TAP5169D/06-02-25/V22. Issue No. 4; Date 06/02/25.

Revision/Date	Change summary
1 02/2023	Initial RDI product for UK market
2 09/2023	Steps 14 & 15 updated with clearer instructions
3 01/2024	RDI IVD product CE registration
4 02/2025	Componentry change: secondary and outer packaging.

If any serious incident occurs in relation to the use of this kit, it should be reported to the manufacturer and the competent authority of the Member State in which the user and/or the patient is established.